

# SIDE

LE GARANZIE PRODOTTO SARANNO APPLICABILI, PER RAGIONI DI SICUREZZA E FRUIBILITÀ, SOLO UTILIZZANDO STRIPLED ED ALIMENTAZIONI NOVALUX. THE PRODUCT WARRANTY CONDITIONS WILL APPLY, DUE TO REASONS OF SAFETY AND QUALITY OF USE, ONLY WHEN INSTALLED WITH THE STRIPLED AND DRIVERS FROM NOVALUX CATALOGUES.



Sistema a scomparsa per realizzare veelette a luce indiretta su cartongesso di spessore 12,5 mm. Profilo dissipante da stuccare e rasare, in lega di alluminio anodizzata naturale e schermo diffusore in policarbonato opale, tagliabili a misura in opera. Diffusore e kit di giunzione inclusi. Strip LED ed alimentatore elettronico da ordinare a parte.

Concealed system to realize indirect light covers for 12,5 mm thickness plasterboard. Dissipating profile made of anodized aluminum alloy natural finish and polycarbonate opal diffuser, cuttable to measure on site. Opal diffuser and junction kit included. Strip LED and electronic driver to be ordered separately.

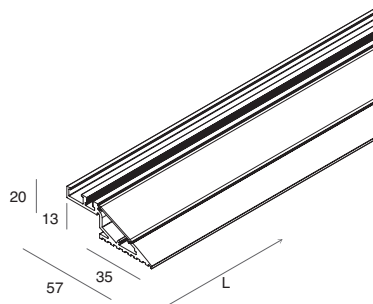

CODE	L (mm)	Diffuser
<b>106901.99</b>	2000	Opale / Opal

## SIDE

### ACCESSORI ACCESSORIES

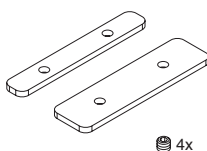

4x

**GIUNTO LINEARE**  
Da prevedere in caso di utilizzo di sezioni di profilo tagliate in opera.

**LINEAR JOINT**  
To be used for sections of profile cut on site.

CODE

**106902.99**

NEW

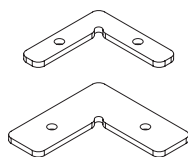

x4

**GIUNTO ANGOLARE**  
Da prevedere in caso di taglio in opera del modulo lineare a 45°

**CORNER JOINT**  
To be provided in case of cutting the linear module at 45°

CODE

**106903.99**

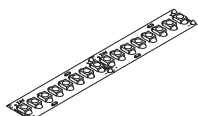

### STRIP LED

Pag. 204

Installabile max 1 strip LED.

Max 1 strip LED can be placed.