

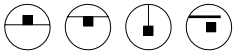

THE PANEL 2



Pannello LED con cornice in lega di alluminio verniciata a polvere di colore bianco, diffusore opale in PMMA resistente ai raggi UV. UGR<19. Installabile ad incasso su controsoffitto a pannelli con struttura a vista senza accessori, per le altre installazioni prevedere gli opportuni accessori da ordinare a parte. Alimentatore elettronico incluso.

LED panel with frame made of white powder coated aluminium alloy, opal diffuser in PMMA, UV resistant. UGR<19. No accessories needed for installation on exposed grid ceiling, accessories for other installations to be ordered separately. Integrated electronic driver.



* Solo versione DALI-PUSH / Only DALI-PUSH version

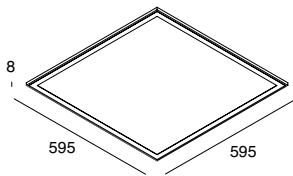

THE PANEL 2
600x600

		3000K <input type="checkbox"/>		4000K <input type="checkbox"/>
35W	3343 lm	102001.01	3447 lm	102002.01
DALI-PUSH				
		3000K <input type="checkbox"/>		4000K <input type="checkbox"/>
35W	3343 lm	102096.01	3447 lm	102097.01

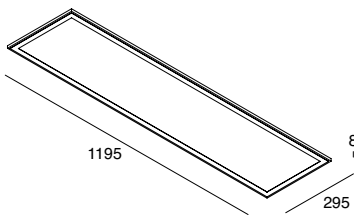

THE PANEL 2
1200x300

		3000K <input type="checkbox"/>		4000K <input type="checkbox"/>
35W	3343 lm	102007.01	3447 lm	102008.01
DALI-PUSH				
		3000K <input type="checkbox"/>		4000K <input type="checkbox"/>
35W	3343 lm	102098.01	3447 lm	102099.01

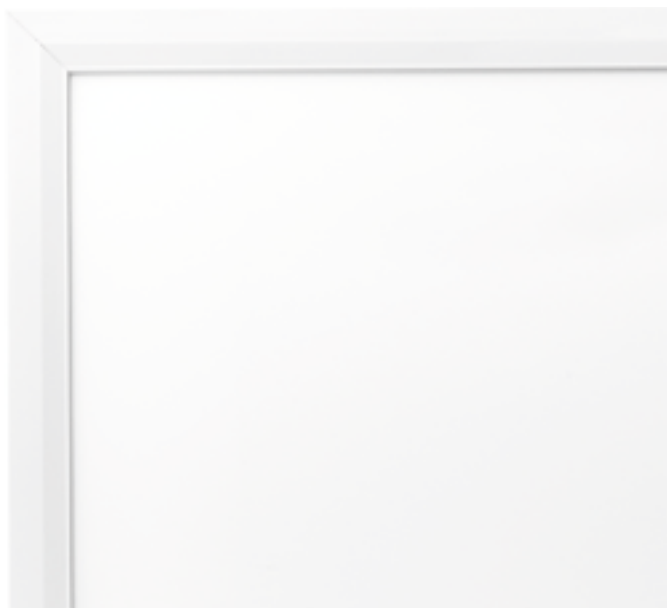

LED PANEL

THE PANEL 2

ACCESSORI PER INSTALLAZIONE AD INCASSO ACCESSORIES FOR RECESSED MOUNTED

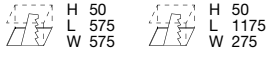
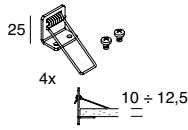

KIT MOLLE PER INSTALLAZIONE
AD INCASSO
Per versioni 600x600 e 1200x300,
per installazione in battuta in cartongesso
di spessore 10-12,5 mm.

16215.99

SPRINGS KIT FOR RECESSED
INSTALLATION
For 600x600 and 1200x300 versions,
for installation by frame contrasting in
plasterboard of thickness 10-12,5 mm.

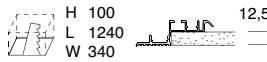
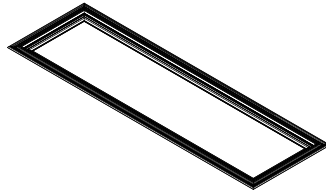
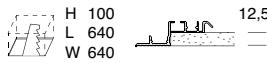
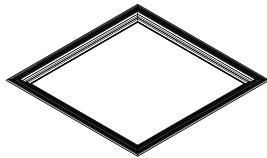

KIT PER INSTALLAZIONE AD INCASSO
A RASAMENTO
Profilo da rasare su cartongesso di
spessore 12,5 mm.
Il pannello si installa in appoggio

KIT FOR LEVELLED
RECESSED INSTALLATION
Profile to be levelled on 12,5 mm thick
plasterboard.

VERSION

102028.99	600x600
102029.99	1200x300

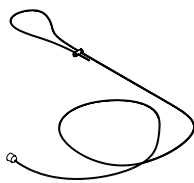

KIT ANTICADUTA
Cavo in acciaio da fissare a soffitto o
strutture tramite morsetto in ottone
nichelato e aggancio a vite sul pannello.

102031.99	L (mm) 3000
------------------	----------------

ANTI FALL-OUT KIT
Steel cable to be fixed to the ceiling or
structures using a nickel-plated brass
clamp and screwed on the panel.

Per accessori di installazione su controsoffitti a struttura nascosta, contattare l'ufficio tecnico Novalux.
For installation accessories on concealed grid ceilings, please contact Novalux technical office.

THE PANEL 2

ACCESSORI PER INSTALLAZIONE A PLAFONE ACCESSORIES FOR CEILING MOUNTED

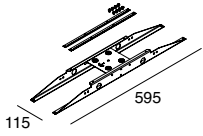

KIT PER INSTALLAZIONE A PLAFONE
Per versioni 600x600 e 1200x300, non installabile a parete o in fila continua. Distanza tra prodotto e soffitto 40 mm.

16213.99

KIT FOR CEILING MOUNTING
For 600x600 and 1200x300 versions, not suitable for wall surface or continuous line installation. Distance between the fixture and the ceiling 40 mm.

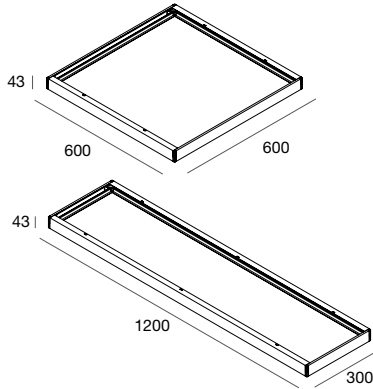

BOX PER INSTALLAZIONE A PLAFONE
Kit da assemblare, non installabile a parete. Idoneo per l'alloggiamento del kit di emergenza (1020A4.99/1020A5.99).

KIT FOR CEILING MOUNTING
To be assembled, not suitable for wall surface mounting. Suitable for emergency kit (1020A4.99/1020A5.99).



VERSION

102086.01 600x600
102087.01 1200x300

THE PANEL 2

ACCESSORI PER INSTALLAZIONE A SOSPENSIONE ACCESSORIES FOR SUSPENSION MOUNTED

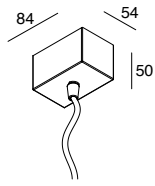

KIT DI ALIMENTAZIONE
PER SOSPENSIONE
Cavo di alimentazione trasparente

POWER SUPPLY KIT
FOR SUSPENSION
Transparent power cable

	L (mm)	Cavo / Cable (mm ²)
<input type="checkbox"/>	1200	3x1,5
108919.01		
108920.01	3000	3x1,5
108921.01	1200	5x1,5
108922.01	3000	5x1,5

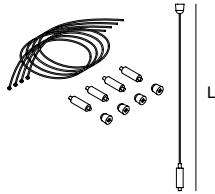

KIT n.4 SOSPENSIONI
per versioni 600x600 e 1200x300.

KIT nos.4 SUSPENSIONS
for 600x600 and 1200x300 versions.

	L (mm)
16223.99	3000

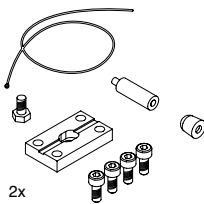

KIT n.2 GIUNTI + SOSPENSIONI
per versioni 600x600 e 1200x300.

KIT nos.2 JOINTS + SUSPENSIONS
for 600x600 and 1200x300 versions.

	L (mm)
<input checked="" type="checkbox"/>	3000
16227.96	

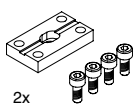

KIT n.2 GIUNTI (privi di sospensioni)
per versioni 600x600 e 1200x300.

KIT nos.2 JOINTS (without suspensions)
for 600x600 and 1200x300 versions.

<input checked="" type="checkbox"/>	16232.96

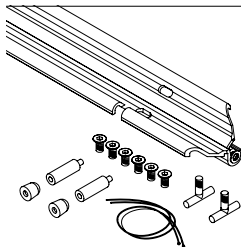

KIT SNODO + n.2 SOSPENSIONI
per versione 600x600
profilo in lega di alluminio verniciato.

KIT HINGE + nos.2 SUSPENSIONS
for 600x600 version
profile in powder coated aluminium alloy.

	L (mm)
<input type="checkbox"/>	3000
16228.01	

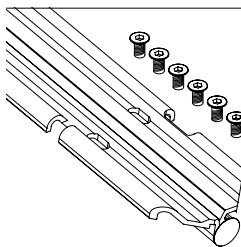

KIT SNODO (privo di sospensioni)
per versione 1200x300
profilo in lega di alluminio verniciato.

KIT HINGE (without suspensions)
for 1200x300 version
profile in powder coated aluminium alloy.

<input type="checkbox"/>	16234.01

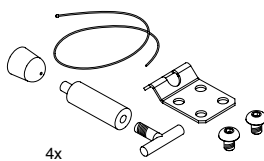

KIT n.4 SOSPENSIONI INCLINATE
per versioni 600x600 e 1200x300

KIT nos.4 INCLINED SUSPENSIONS
for 600x600 and 1200x300 versions

	L (mm)
16230.99	3000

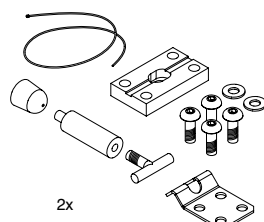

KIT n.2 GIUNTI + SOSPENSIONI +
STAFFE INCLINATE
per versione 600x600.

KIT nos.2 JOINTS + SUSPENSIONS +
INCLINED BRACKETS
for 600x600 version.

	L (mm)
<input checked="" type="checkbox"/>	3000
16231.96	

THE PANEL 2

COMPOSIZIONI SOPPESE SUSPENDED COMPOSITIONS

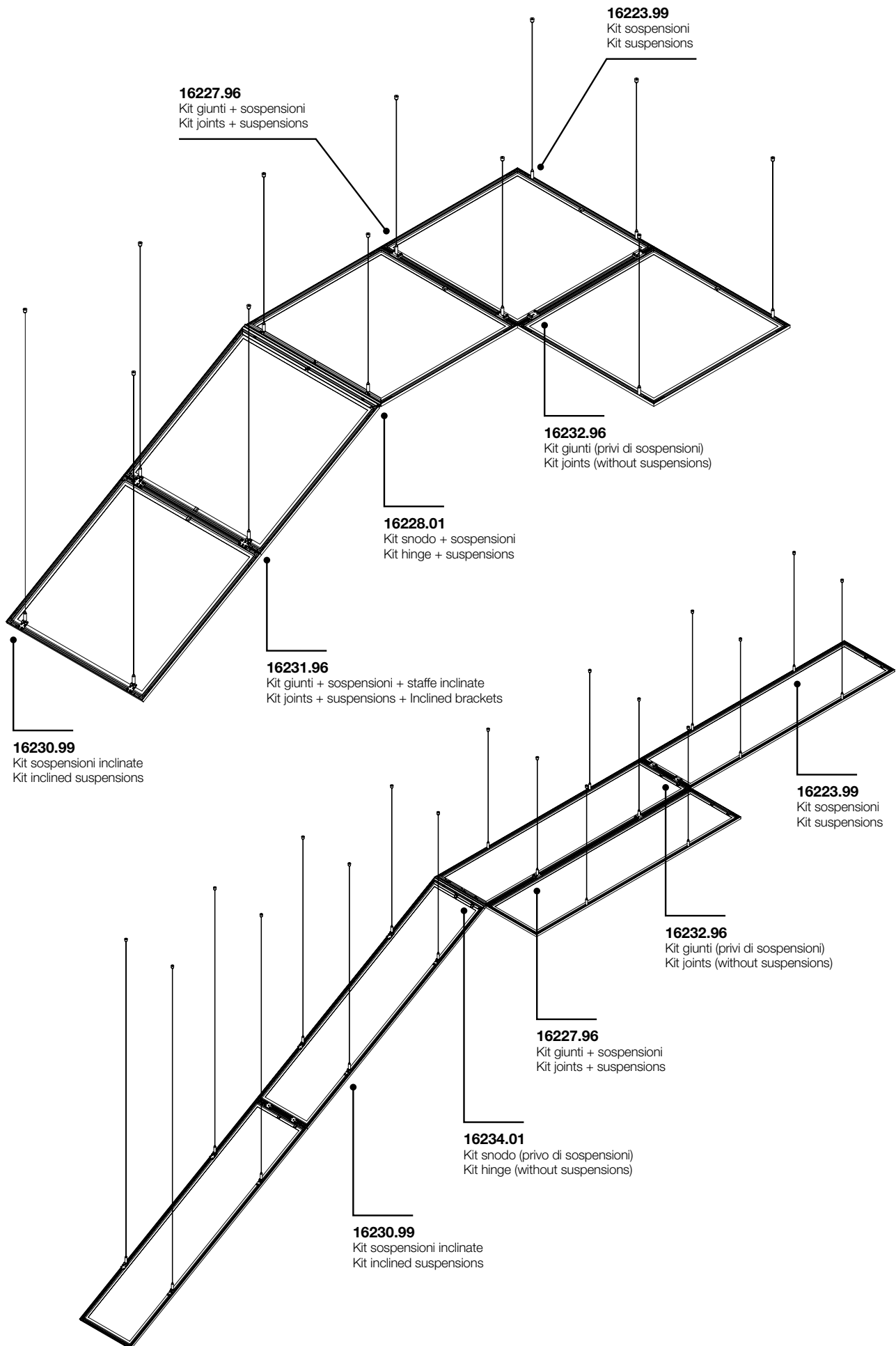

THE PANEL 2

ACCESSORI PER INSTALLAZIONE A BINARIO ACCESSORIES FOR TRACK MOUNTED

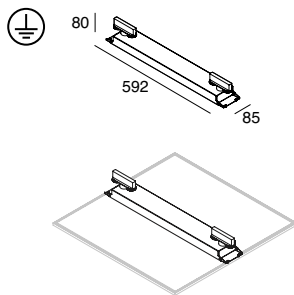

KIT BINARIO 600x600
completo di 2 adattatori
(elettrico/meccanico)
per binario elettrificato All-Track.

KIT FOR TRACK MOUNTING 600x600
supplied with 2 adaptors
(electrical/mechanical)
for electrified All-Track.

VERSION

102055.01 3P+DALI
102053.01 3P

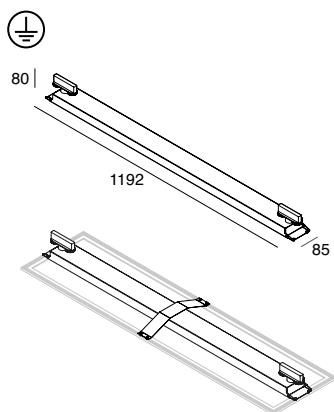

KIT BINARIO 1200x300
completo di 2 adattatori
(elettrico/meccanico)
per binario elettrificato All-Track.

KIT FOR TRACK MOUNTING 1200x300
supplied with 2 adaptors
(electrical/mechanical)
for electrified All-Track.

CODE VERSION

102056.01 3P+DALI
102054.01 3P

THE PANEL 2

ACCESSORI EMERGENZA ACCESSORIES EMERGENCY

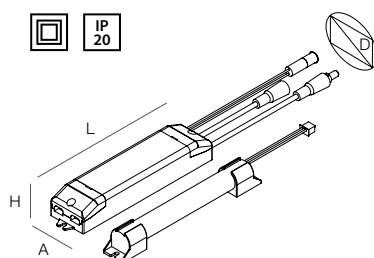

KIT DI ALIMENTAZIONE
IN EMERGENZA
Per versioni 600x600 e 1200x300, per
installazione ad incasso o a plafone con
Box (102086.01, 102087.01).
Completo di connettori polarizzati per il
collegamento dell'alimentatore.

KIT FOR EMERGENCY
For 600x600 and 1200x300 versions,
for recessed installation or ceiling
installation with Box
(102086.01, 102087.01)
Polarized connectors included.

	TIME CHARGE		A (mm)	D (mm)	H (mm)	L (mm)	
1020A4.99	1h	12h	38	44	25	164	
1020A5.99	3h	12h	38	44	25	164	
Flusso in emergenza - Emergency flux						1h	3h
THE PANEL 2			35W	12%	5%		

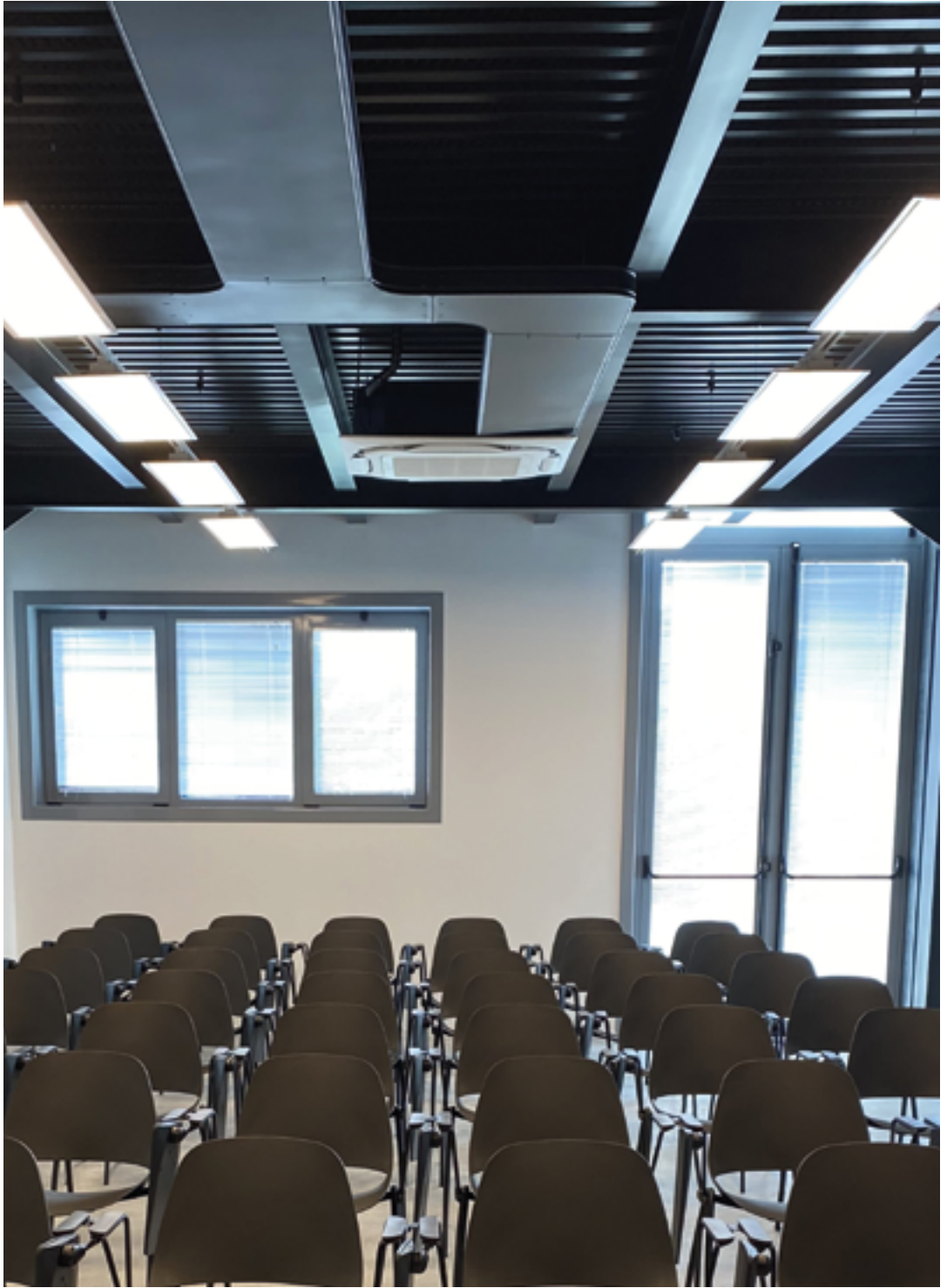

LED PANEL